

ah! Superwood

ah!SW

introduction

With the same aluminum core of the ah!38 series, ah!Superwood incorporates wood for excellent performance and exquisite aesthetic.

By combining those materials, ah!SW benefits from the best features each has to offer: aluminum's mechanical resistance and low maintenance, even when exposed to the most demanding weather conditions, alongside the comfort of a natural material like wood and its thermal efficiency.

To overcome the technical shortcomings often associated with wood and to ensure a more stable material, we introduce Superwood – a pine wood species subjected to a chemical structure reorganization process which improves its properties.

This enhanced wood is suitable for both interior and exterior cladding.

invisible frame sliding system

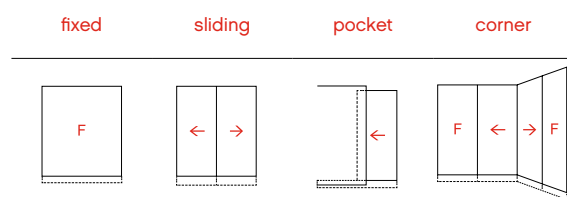

	fixed	sliding	pocket	corner
monorail	•		•	•
birail	•	•	•	•
multirail	•	•	•	•

main dimensions

vertical profile	35mm		
max. leaf height	6000mm		
max. leaf width	6000mm		
max. weight	up to 1.000kg / glass pannel		
max. glazed area	double glazing	up to 19m ²	
	triple glazing	up to 6m ²	
glass thickness	38mm		

construction

add-ons Insect screens / heated glass / intrusion detectors / balustrade / soft close

motorisation Our motorisation system can be adapted to all sliding or opening systems allowing a full integration with minimum interference in architectural design with a simplified and very quiet opening.

performance

light transmission	up to 98%
thermal coefficient	Uw = 1.165W/m ² .K (Ug = 0.7W/m ² .K)
security	RC2 / WK2
sound insulation	41dB
water tightness	Class E900
air tightness	Class 4
wind tightness	Class C5

Superwood

- 1 ah! Superwood main frame
- 2 polyamide
- 3 central mullion
- 4 glass

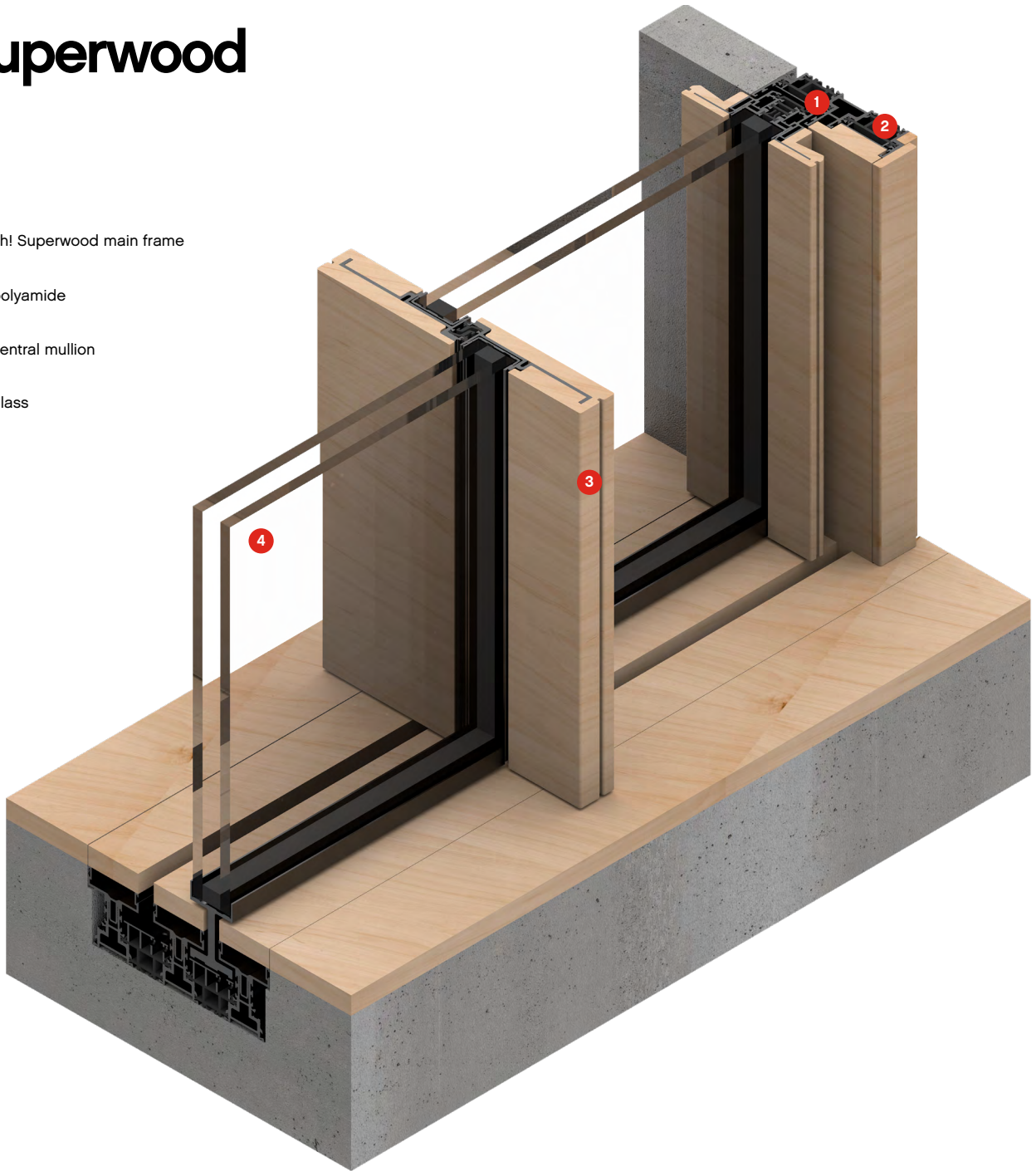

finishes

aluminium finishes

All **panoramah!**® System series guarantee that the following finishes are carried out by duly certified entities, according to QUALICOAT and QUALANOD directives: Lacquered RAL, Lacquered PVDS, Anodized, Satin, Polished and Repellent.

opaque coating

A film forming, opaque coating system, water-based.

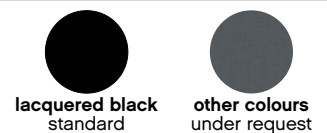

translucent coating

A film forming, stained coating system, water-based, with 8 colours available.



SW1
Bamboo



SW2
Teak



SW3
Mahogany



SW4
Brown



SW5
Walnut



SW6
Brown walnut



SW7
Dark Walnut



SW8
Rosewood

SW

customization

With **ah!SW** it is possible to design numerous aluminum/wood combinations, adapted to the specificities of each project, creating a customized configuration.

combinations examples:

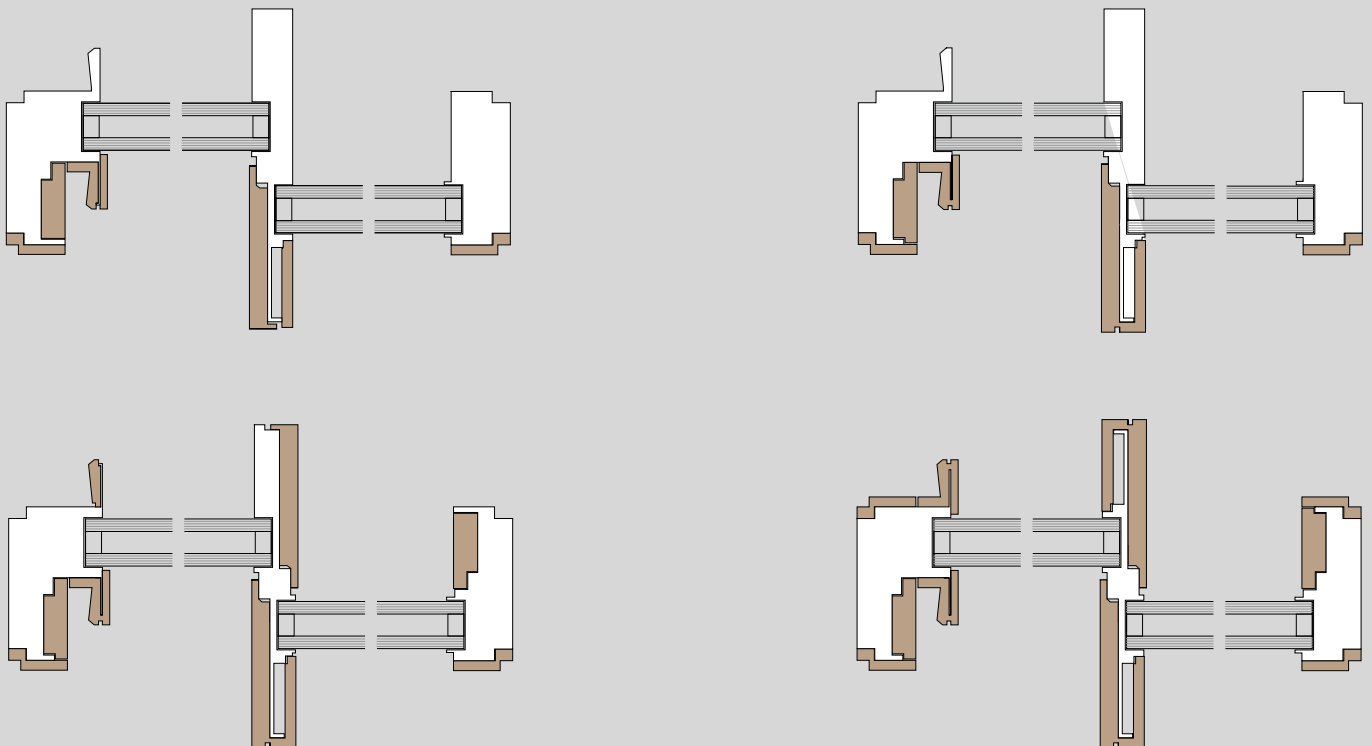

ah!SW

sliding birail option A common sections

1:3

scale

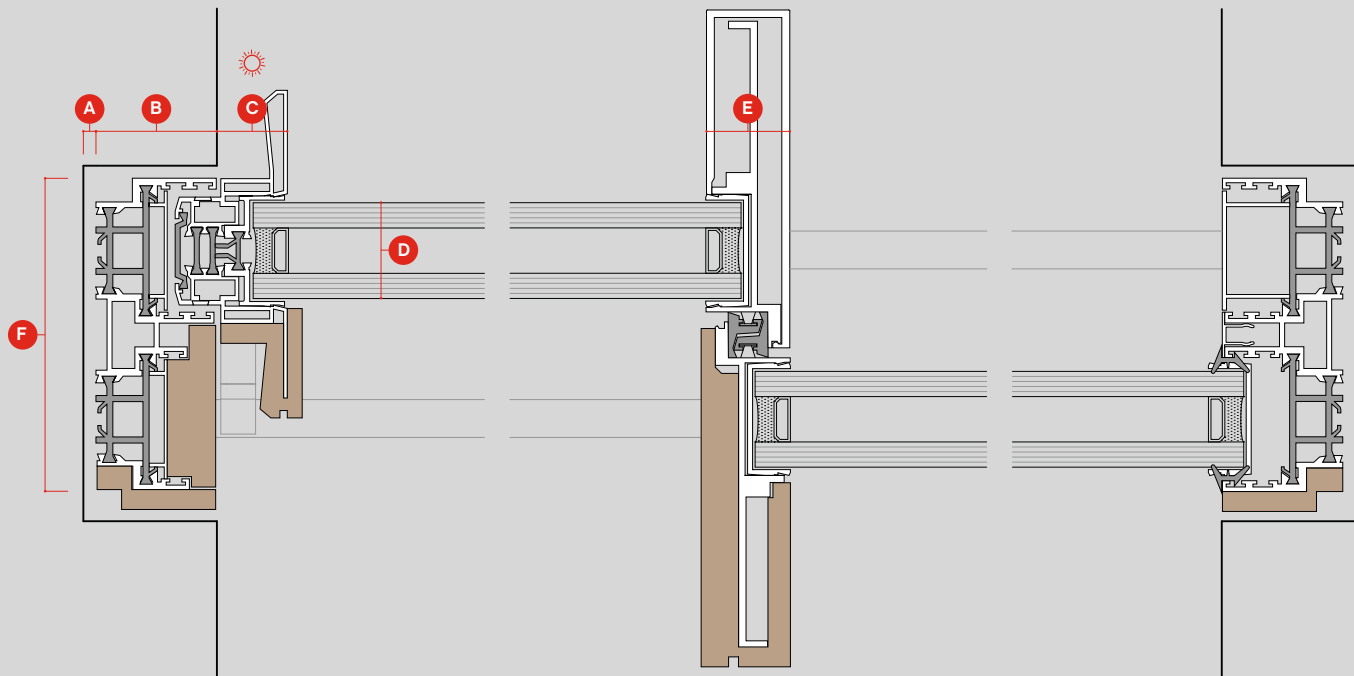

dimensions and main components

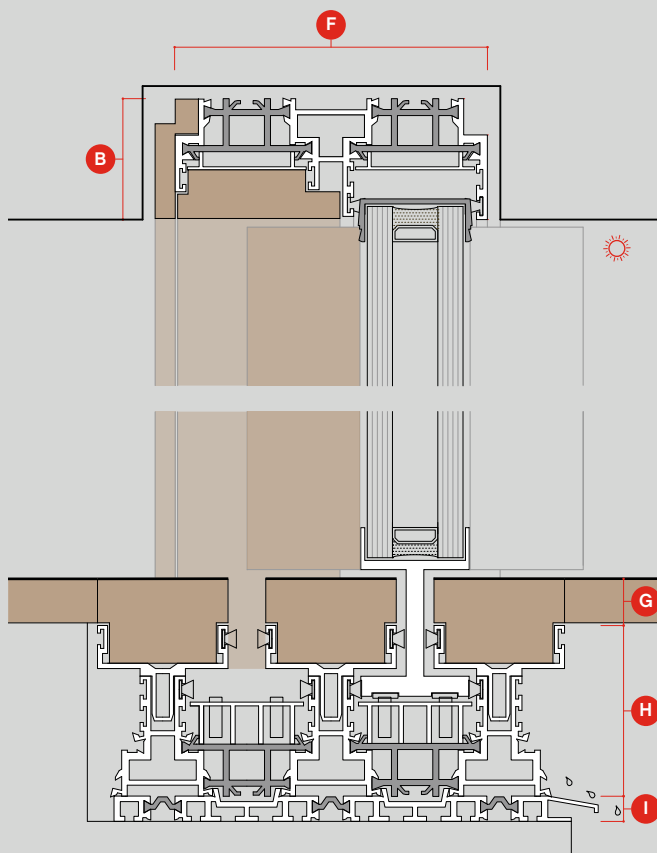

- | | |
|---------------|----------------|
| A 5mm | F 124mm |
| B 48mm | G 19mm |
| C 27mm | H 68mm |
| D 38mm | I 10mm |
| E 33mm | |

ah!SW

sliding birail option B common sections

1:3

scale

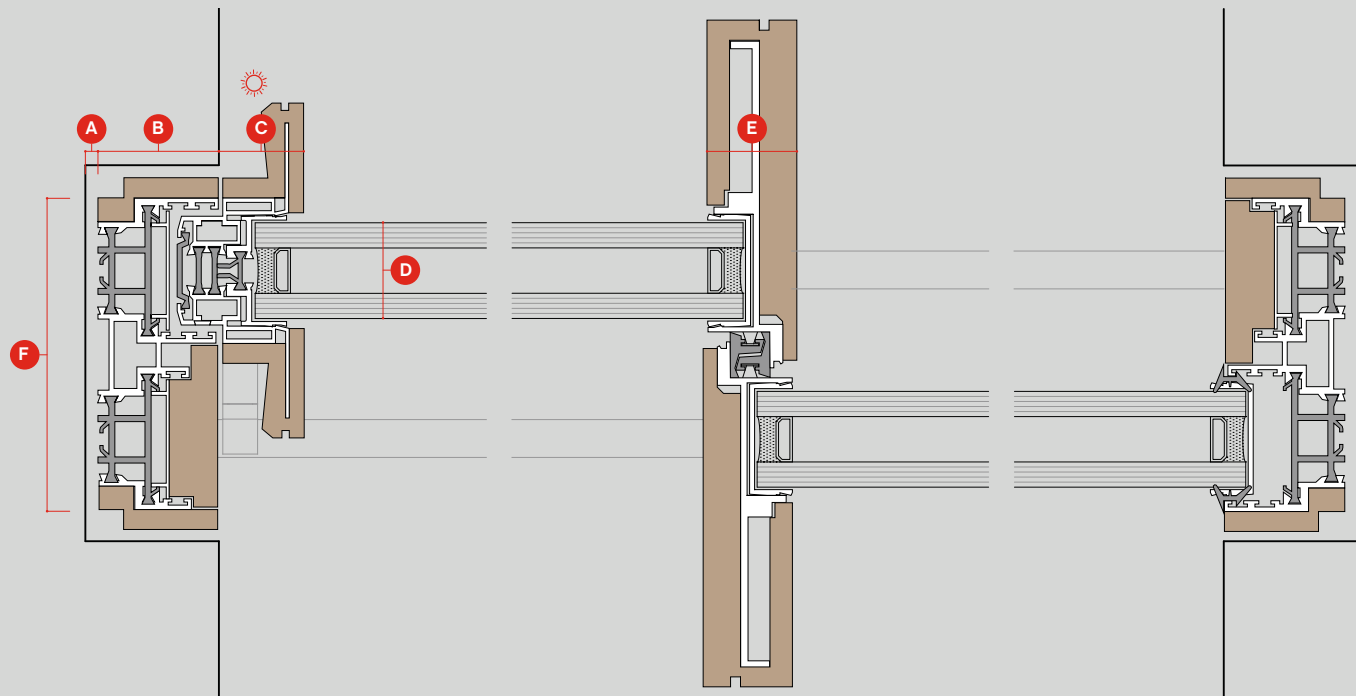

dimensions and main components

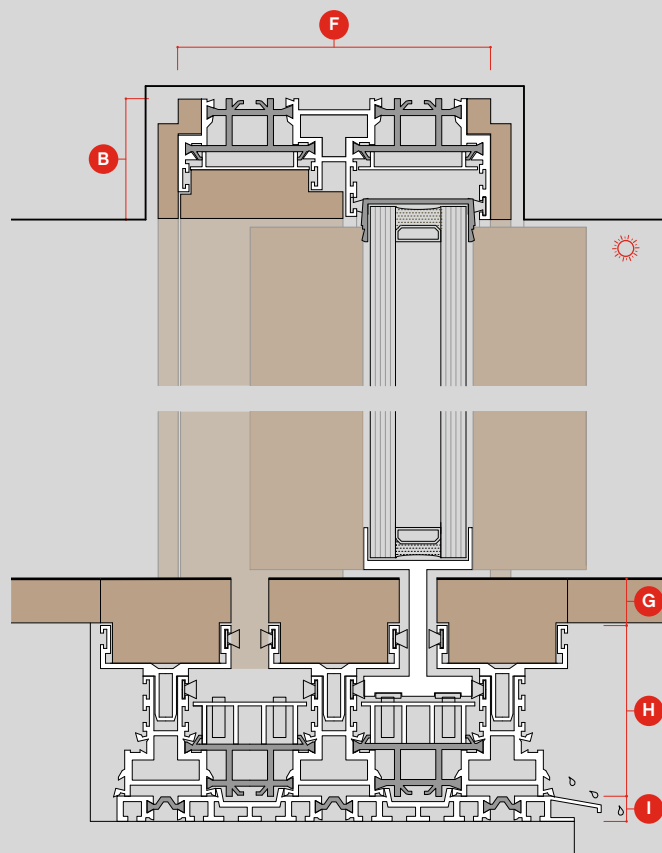

A 5mm	F 124mm
B 48mm	G 19mm
C 34mm	H 68mm
D 38mm	I 10mm
E 35mm	

we build ah!



unlimited perspective sa
ch philibert-de-sauvage 37
1219 chatelaine
switzerland

p. +41 21 804 1700
f. +41 21 804 1709

info@panoramah.com
www.panoramah.com

facebook
www.facebook.com/panoramah.ch/

instagram
www.instagram.com/_panoramah_/